HP V281C/D and W281C/D 1.0 mm Coaxial to Waveguide Adapters

Operating and Service Manual

Notice

The information contained in this document is subject to change without notice.

Hewlett-Packard makes no warranty of any kind with regard to this material, including, but not limited to, the implied warranties of merchantability and fitness for a particular purpose. Hewlett-Packard shall not be liable for errors contained herein or for incidental or consequential damages in connection with the furnishing, performance, or use of this material.

Hewlett-Packard assumes no responsibility for the use or reliability of its software on equipment that is not furnished by Hewlett-Packard.

This document contains proprietary information which is protected by copyright. All rights are reserved. No part of this document may be photocopied, reproduced, or translated to another language without prior written consent of Hewlett-Packard Company.

Restricted Rights Legend

Use, duplication, or disclosure by the U.S. Government is subject to restrictions as set forth in subparagraph (c)(1)(ii) of the Rights in Technical Data and Computer Software clause at DFARS 252.227-7013 for DOD agencies, and subparagraphs (c)(1) and (c)(2) of the Commercial Computer Software Restricted Rights clause at FAR 52.227-19 for other agencies.

Hewlett-Packard Company
Santa Rosa Systems Division
1400 Fountaingrove Parkway
Santa Rosa, CA 95403-1799, U.S.A.

© Copyright Hewlett-Packard Company 1998

Warranty

Certification

Hewlett-Packard Company certifies that this product met its published specifications at the time of shipment from the factory. Hewlett-Packard further certifies that its calibration measurements are traceable to the United States National Institute of Standards and Technology (NIST, formerly NBS), to the extent allowed by the Institute's calibration facility, and to the calibration facilities of other International Standards Organization members.

Warranty

This Hewlett-Packard product is warranted against defects in materials and workmanship for a period corresponding to the individual warranty periods of its component products. Instruments are warranted for a period of one year. During the warranty period, Hewlett-Packard Company will, at its option, either repair or replace products that prove to be defective.

Warranty service for products installed by HP and certain other products designated by HP will be performed at Buyer's facility at no charge within HP service travel areas. Outside HP service travel areas, warranty service will be performed at Buyer's facility only upon HP's prior agreement and Buyer shall pay HP's round trip travel expenses. In all other areas, products must be returned to a service facility designated by HP

For products returned to HP for warranty service, Buyer shall prepay shipping charges to HP and HP shall pay shipping charges to return the product to Buyer. However, Buyer shall pay all shipping charges, duties, and taxes for products returned to HP from another country.

HP warrants that its software and firmware designated by HP for use with an instrument will execute its programming instructions when properly installed on that instrument. HP does not warrant that the operation of the instrument, or software, or firmware will be uninterrupted or error free.

LIMITATION OF WARRANTY. The foregoing warranty shall not apply to defects resulting from improper or inadequate maintenance by Buyer, Buyer-supplied software or interfacing, unauthorized modification or misuse, operation outside of the environmental specifications for the product, or improper site preparation or maintenance.

NO OTHER WARRANTY IS EXPRESSED OR IMPLIED. HP SPECIFICALLY DISCLAIMS THE IMPLIED WARRANTIES OR MERCHANTABILITY AND FITNESS FOR A PARTICULAR PURPOSE.

EXCLUSIVE REMEDIES. THE REMEDIES PROVIDED HEREIN ARE BUYER'S SOLE AND EXCLUSIVE REMEDIES. HP SHALL NOT BE LIABLE FOR ANY DIRECT, INDIRECT, SPECIAL, INCIDENTAL, OR CONSEQUENTIAL DAMAGES, WHETHER BASED ON CONTRACT, TORT, OR ANY OTHER LEGAL THEORY.

Assistance

Product maintenance agreements and other customer assistance agreements are available for Hewlett-Packard products.

For assistance, call your local Hewlett-Packard Sales and Service Office (refer to "Support and Service").

Support and Service

Any adjustment, maintenance, or repair of this product must be performed by qualified personnel. Contact your local HP sales and service office.

US Field Operation Headquarters

Hewlett-Packard Company
19320 Pruneridge Avenue
Cupertino, CA 95014
USA
(800) 752-0900

Southern California

Hewlett-Packard Company
1421 South Manhattan Avenue
Fullerton, CA 92631
(714) 999-6700

Northern California

Hewlett-Packard Company
301 E. Evelyn
Mountain View, CA 94041
(415) 694-2000

Colorado

Hewlett-Packard Company
24 Inverness Place, East
Englewood, CO 80112
(303) 649-5000

Georgia

Hewlett-Packard Company
2000 South Park Place
Atlanta, GA 30339
(404) 9554-1500

Illinois

Hewlett-Packard Company
5201 Tollview Drive
Rolling Meadows, IL 60008
(708) 342-2000

New Jersey

Hewlett-Packard Company
West 120 Century Road
Paramus, NJ 07653
(201) 599-5000

Texas

Hewlett-Packard Company
930 E. Campbell Road
Richardson, TX 75081
(214) 231-6101

European Operations Headquarters

Hewlett-Packard S.A.
150, route du Nant-d'Avril
1217 Meyrin 2/Geneva
Switzerland
(41 22) 780.8111

France

Hewlett-Packard France
1 avenue du Canada
Zone d'Activite de Courtaboeuf
F-91947 Les Ulis Cedex
France
(33 1) 69 82 60 60

Germany

Hewlett-Packard GmbH
Hewlett-Packard-Strasse
61352 Bad Homburg
Germany
(+49 6172) 16-0

Great Britain

Hewlett-Packard Ltd.
Eskdale Road
Winkersley Triangle
Wokingham, Berkshire RG11 5DZ
England
(44 734) 696622

Intercon Operations Headquarters

Hewlett-Packard Company
3495 Deer Creek Road
Palo Alto, CA 94304-1316
USA
(415) 857-5027

Australia

Hewlett-Packard Australia, Ltd.
31-41 Joseph Street
Post Office Box 221
Blackburn, Victoria 3130
Australia
(61 3) 895-2895

Canada

Hewlett-Packard (Canada), Ltd.
17500 South Service Road
Trans-Canada Highway
Kirkland, Quebec H9J 2X8
Canada
(514) 697-4232

China

China Hewlett-Packard Co., Ltd.
38 Bei San Huan Road
Shuang Yu Shu
Hai Dian District, Beijing
China
(86 1) 256-6888

Japan

Yokogawa-Hewlett-Packard, Ltd.
1-27-15 Yabe
Sagamihara
Kanagawa 229
Japan
(81 427) 59-1311

Singapore

Hewlett-Packard Singapore (Pte.), Ltd.
Alexandra Post Office Box 87
Singapore 9115
(65) 271-9444

Taiwan

Hewlett-Packard Company
8th Floor
337 Fu Hsing North Road
Taipei
Taiwan
(866 2) 712-0404

Contents

Notice	iv
Warranty	v
Certification	v
Warranty	v
Assistance	vi
Support and Service	vii
1. General Information	
1.0 mm Connector Overview	1-1
About This Manual	1-1
Serial Numbers	1-1
Incoming Inspection	1-1
Clarifying Connector Sex	1-2
<i>Figure 1-1. Male and Female Connectors.</i>	1-2
Preventive Maintenance	1-2
2. Specifications	
Environmental Requirements	2-1
<i>Table 2-1. Environmental Requirements.</i>	2-1
Temperature –What To Watch Out For	2-1
Electrical Specifications	2-2
HP V281C and HP V281D	2-2
HP W281C and HP W281D	2-2
Mechanical Characteristics	2-2
Center Conductor Protrusion and Pin Depth	2-2
Supplemental Mechanical Characteristics	2-2
<i>Table 2-2. Typical 1.0 mm Connector Characteristics.</i>	2-2
<i>Table 2-3. Supplemental Characteristics</i>	2-3
Mechanical Dimensions	2-4
<i>Figure 2-1. HP V281C/D and HP W281C/D Dimensions</i>	2-4
3. Making Connections	
Electrostatic Discharge	3-1
Supplies and Equipment Required but Not Supplied	3-1
Visual Inspection	3-2
Required Inspection Tools	3-2
Obvious Defects or Damage	3-2
Connector Contacts	3-3
<i>Figure 3-1. Contact Integrity</i>	3-3
Concentricity	3-3

<i>Figure 3-2. Concentricity - Female Connector</i>	3-3
<i>Figure 3-3. Concentricity - Male Connector</i>	3-4
Mating Plane Surfaces	3-4
Damaged Connectors	3-4
Connector Wear	3-4
Pin Depth	3-5
Protrusion and Recession	3-5
<i>Figure 3-4. Connector Pin Depth</i>	3-6
Making Connections	3-7
1.0 mm Connector Alignment	3-7
<i>Figure 3-5. Alignment</i>	3-8
1.0 mm Connector Misalignment	3-8
<i>Figure 3-6. Forced Misalignment</i>	3-8
Cleaning Connectors	3-9
Supplies and Equipment Needed	3-9
Basic Cleaning Procedure	3-9
<i>Figure 3-7. Cleaning Illustration</i>	3-9
Making a Connection	3-10
Connection Procedure	3-10
Connecting Waveguides	3-10
Using the Torque Wrench	3-11
<i>Table 3-1. Torque Wrench Information</i>	3-11
Torque Wrench Procedure	3-11
Disconnection Procedure	3-12
Handling and Storage	3-13
4. Replaceable Parts	
<i>Table 4-1. Replaceable Parts</i>	7-1

1

General Information

1.0 mm Connector Overview

These adapters are used for the measurement of components with 50 Ω 1.0 mm connectors with a frequency range from DC to 110 GHz.

The 1.0 mm connector utilizes an air dielectric interface for the highest accuracy and repeatability. The coupling diameter and thread size were chosen to maximize strength, increase durability and provide highly repeatable connections. The connectors are designed so that the outer conductors engage before the center conductors.

To obtain the best performance possible, the manufacturing tolerances of the connectors are tighter than the standard 1.0 mm specifications per the IEEE 287 connector standard.

About This Manual

This manual describes the HP V281C/D and HP W281C/D coaxial to waveguide adapters and provides replacement part numbers, specifications, and procedures for using and maintaining the adapters.

Throughout this manual, the HP V281C/D and HP W281C/D coaxial to waveguide adapters will be referred to as the V and W-band Adapters.

Serial Numbers

A serial number label is attached to each adapter. The serial number is made up of five numbers and is unique to each adapter.

Incoming Inspection

Hewlett-Packard will arrange for repair or replacement of incomplete or damaged shipments without waiting for a settlement from the transportation company. When you send a device to Hewlett-Packard, include the following information:

- Your company name and address.
- A technical contact person within your company, and the person's complete phone number.
- If you are returning one or more devices, include the part numbers and serial numbers.
- Indicate the type of service required.
- Include any applicable information.

Clarifying Connector Sex

In this manual, connectors are referred to in terms of their device sex

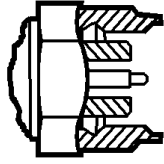

Male Connector

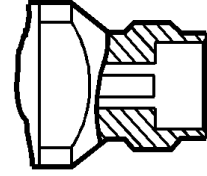

Female Connector

Figure 1-1 Male and Female Connectors

Preventive Maintenance

The best techniques for maintaining the integrity of these adapters is to include routine visual inspection (using 10X magnification), cleaning and proper connection techniques. Failure to detect and remove dirt or metallic particles on a mating plane surface can degrade repeatability and accuracy, and can damage any connector mated to it. Improper connections resulting from poor connection techniques can also damage these devices.

Visual inspection, cleaning techniques, and connection techniques are all described in Chapter 3, “Making Connections”.

2

Specifications

Environmental Requirements

Table 2-1 Environmental Requirements

Parameter	Required Values/Ranges
Operating Temperature	0° to 55° C (32° to 131° F)
Storage Temperature	-40° to +75° C (-40° to +167° F)
Altitude	
Operation	< 15,000 meters (≈ 50,000 feet)
Storage	< 15,000 meters (≈ 50,000 feet)
Relative Humidity	Always Non-Condensing
Operation	0 to 80% (26° C maximum dry bulb)
Storage	0 to 90%

Temperature –What To Watch Out For

Due to the critical dimensions and tight tolerances of the 1.0 mm connectors on your adapters, electrical characteristics will change with temperature. The operating temperature is a critical factor in the performance during measurements and between calibrations.

NOTE

Remember your fingers are a heat source, so avoid handling the devices unnecessarily during calibration.

Electrical Specifications

HP V281C and HP V281D

Frequency Range 50 to 75 GHz

Return Loss (at coaxial port only). -16 dB max

HP W281C and HP W281D

Frequency Range 75 to 110 GHz

Return Loss (at coaxial port only). -16 dB max

Mechanical Characteristics

Center Conductor Protrusion and Pin Depth

Mechanical characteristics such as center conductor protrusion and pin depth are *not* performance specifications. They are important supplemental characteristics related to electrical performance. Hewlett–Packard verifies the mechanical characteristics of the V and W-band adapters with special gaging processes and electrical testing. This ensures that the adapter connectors do not exhibit any center conductor protrusion and have proper pin depth when they leave the factory.

Supplemental Mechanical Characteristics

Supplemental mechanical characteristics are values which are typically met by the majority of the adapters tested at Hewlett–Packard. These supplemental characteristics are intended to provide useful information. These are typical but non-warranted performance parameters. The following table lists the typical mechanical characteristics of the 1.0 mm connectors in the V and W-band adapters.

Table 2-2 Typical 1.0 mm Connector Characteristics

Characteristic	Typical Value
Inside Diameter of Outer Conductor	1.000 ± 0.005 mm
Outside Diameter of Center Conductor	0.434 ± 0.005 mm
Pin Depth	0 (flush) to 0.020 mm (maximum recession)
Flatness of Reference Plane	0.005 mm (worst case)

Table 2-3 Supplemental Characteristics

	HP V281C/D	HP W281C/D
Maximum Power:		
@ 75, 110 GHz	12W	12W
Ambient	25 degrees	25 degrees
Net Weight		
	0.1 kg	0.1 kg
	0.2 lbs	0.2 lbs
Waveguide Designator:		
EIA	WR-15	WR-10
MIL-W-85	3-018	3-024
Flange Designator:		
UG - () / U	385	387
MIL - F - 3922 / ()	67B - 002	67B - 010
Insertion Loss	-0.8 dB max	-1.0 dB max
Repeatability ¹	-45 dB max	-40 dB max

1. Repeatability = $20 \log \left| \frac{\Delta \Gamma}{\Gamma} \right|$ where $\Gamma = \Gamma_{m1} - \Gamma_{m2}$. This is the difference between two measurements Γ_{m1} and Γ_{m2} before and after one disconnect/connect cycle at the coax port. Repeatability depends upon proper torque and pin depth.

Mechanical Dimensions

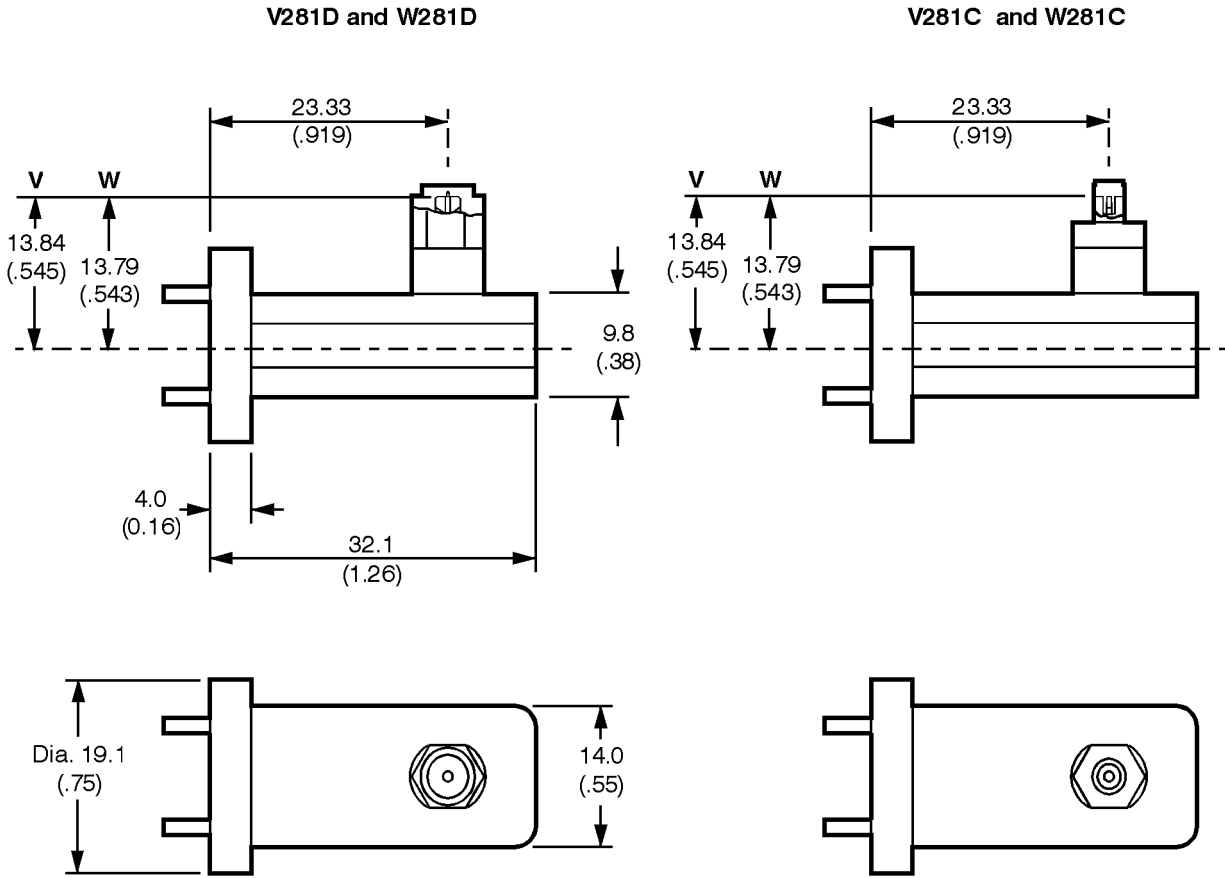

w281cd

Figure 2-1 HP V281C/D and HP W281C/D Dimensions

Making Connections

Electrostatic Discharge

Protection against ESD (electrostatic discharge) is essential while cleaning, inspecting, or connecting any connector attached to a static-sensitive circuit (such as those found in test sets).

Static electricity builds up on the body, and can easily damage sensitive internal circuit elements when discharged by contact with the center conductor of a connector. Static discharges too small to be felt can cause permanent damage. Devices such as calibration and verification components, and devices under test can also carry an electrostatic charge.

- Always have a grounded antistatic mat in front of your test equipment and wear a grounded wrist strap attached to it.
- Ground yourself before you clean, inspect, or make a connection to a static-sensitive device or test port. You can, for example, grasp the grounded outer shell of the test port briefly to discharge static from your body.
- Discharge static electricity from a device before connecting it: touch the device briefly (through a resistor of at least 1 M Ω) to either the outer shell of the test port, or to another exposed ground. This discharges static electricity and protects test equipment circuitry.

Supplies and Equipment Required but Not Supplied

Various connector cleaning supplies and electrostatic discharge safety supplies are *not* provided in this kit. For cleaning and inspection, a 10X magnifying glass is available (Refer to Chapter 4, “Replaceable Parts” for ordering information.)

Visual Inspection

Visual inspection, and if necessary, cleaning should be done every time a connection is made. Metal particles from the connector threads may fall into the connector when it is disconnected. One connection made with a dirty or damaged connector can damage both connectors beyond repair.

Required Inspection Tools

A minimum magnification of 10X is required to inspect the mating surfaces, connector contacts and concentricity of the 1.0 mm connectors. It is also necessary to use good lighting (such as a halogen task light) to see the damage on a connector. Use the guidelines in “Obvious Defects or Damage” when evaluating the integrity of your connectors.

Obvious Defects or Damage

Examine the connectors first for obvious defects or damage:

- Plating
 - ▲ Bare metal showing
 - ▲ Burrs or blisters
- Deformed threads
- Center Conductors
 - ▲ Bent
 - ▲ Broken
 - ▲ Misaligned
 - ▲ Concentricity

Connector nuts should move smoothly and be free of:

- Burrs
- Loose metal particles
- Rough spots

Any connector that has obvious defects should be discarded. See Figure 3-1, Figure 3-2, and Figure 3-3 for visual inspection guidelines.

Connector Contacts

A minimum magnification of 10X is required to inspect the connector contacts. You must also use a magnifying glass to inspect for contact integrity. It is necessary to use good lighting (such as a halogen task light) to see the contacts.

NOTE

Notice the location of the cross hairs in relationship to the center of the following figures.

See Figure 3-1 for visual guidelines when evaluating the contact integrity of a connector.

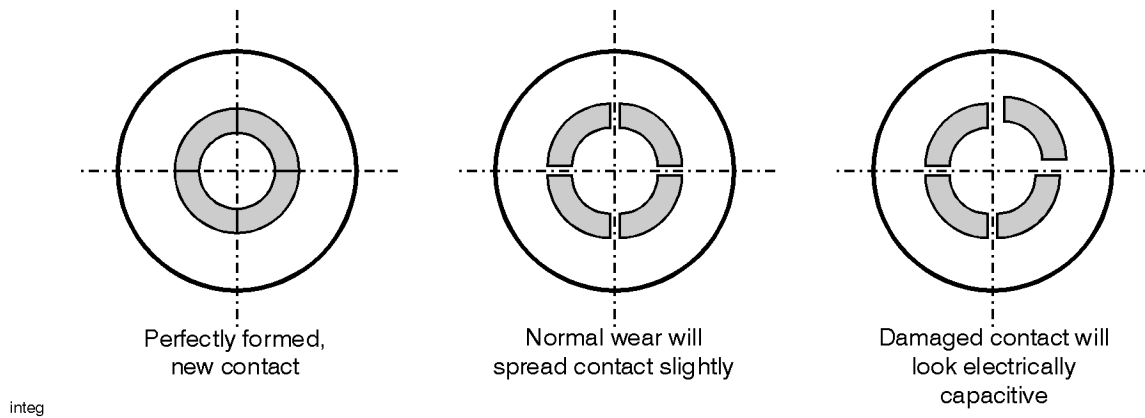

Figure 3-1 Contact Integrity

Concentricity

Figure 3-2 and Figure 3-3 show the concentricity of both the male and female 1.0 mm connectors.

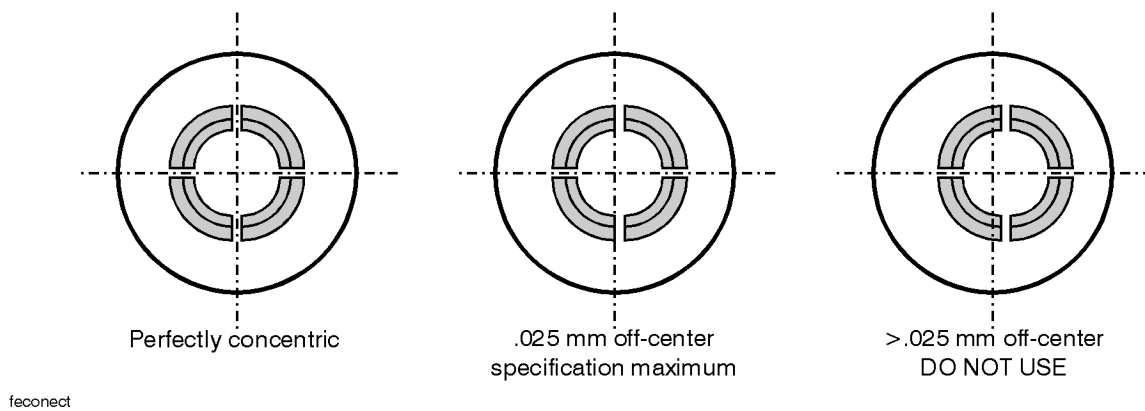

Figure 3-2 Concentricity - Female Connector

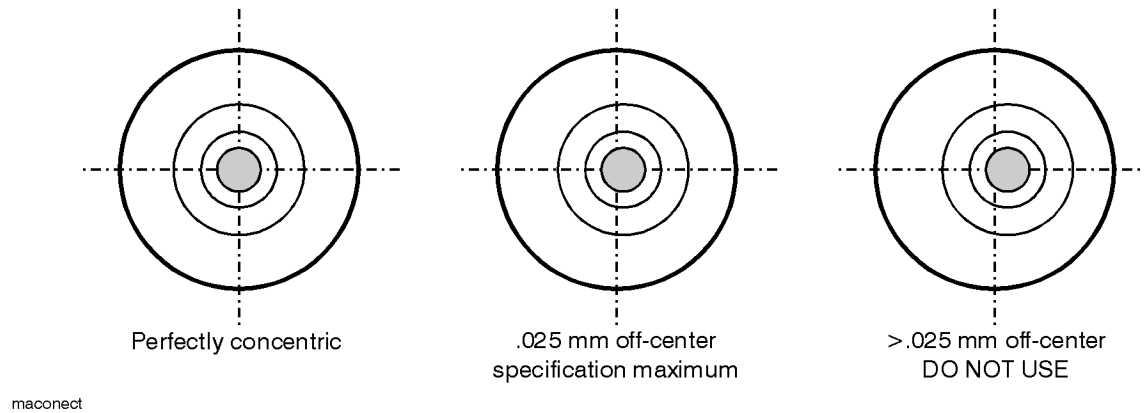

Figure 3-3 Concentricity - Male Connector

Mating Plane Surfaces

Flat contact between the connectors at all points on their mating plane surface is required for a good connections.

Look for deep scratches or dents, and for dirt and metal particles on the connector mating plane surfaces. Also look for “dings” on the mating plane surfaces of the center and outer conductors, and for signs of damage due to misalignment and excessive or uneven wear.

A light burnishing of the mating plane surface is normal. This is evident as light scratches, or shallow circular marks distributed more or less uniformly over the mating plane surface. Other small defects and cosmetic imperfections are also normal. None of these affect electrical or mechanical performance.

Clean and inspect the connector again if it shows:

- Deep scratches or dents
- Particles clinging to the mating plane surface
- Uneven wear

Damaged Connectors

If you find a damaged connector, try to determine the cause of the damage *before* connecting a new, undamaged connector in the same configuration. Damaged connectors should be discarded.

Connector Wear

Connector wear eventually degrades performance. The more use a connector gets, the faster it wears and degrades. The wear is greatly accelerated when connectors are not kept clean. When your connectors become worn, replace them.

Pin Depth

Pin depth is the distance that the center conductor mating plane differs from being flush with the outer conductor mating plane. The pin depth of a connector can be in one of two states, either protruding or recessed.

Protrusion and Recession

- **Protrusion** - the center conductor *extends* beyond the outer conductor mating plane.

NOTE

At *no* time should the pin depth of the 1.0 mm connector be protruding.

- **Recession** - the center conductor is *set back* from the outer conductor mating plane.

The pin depth value of each adapter was verified to be within factory specifications at shipment. The electrical performance of the adapter depends, to some extent, on its pin depth. The electrical specifications for each adapter takes into account the effect of pin depth on the adapters performance. See Figure 3-4 for a visual representation of proper pin depth (slightly recessed).

Making Connections
Pin Depth

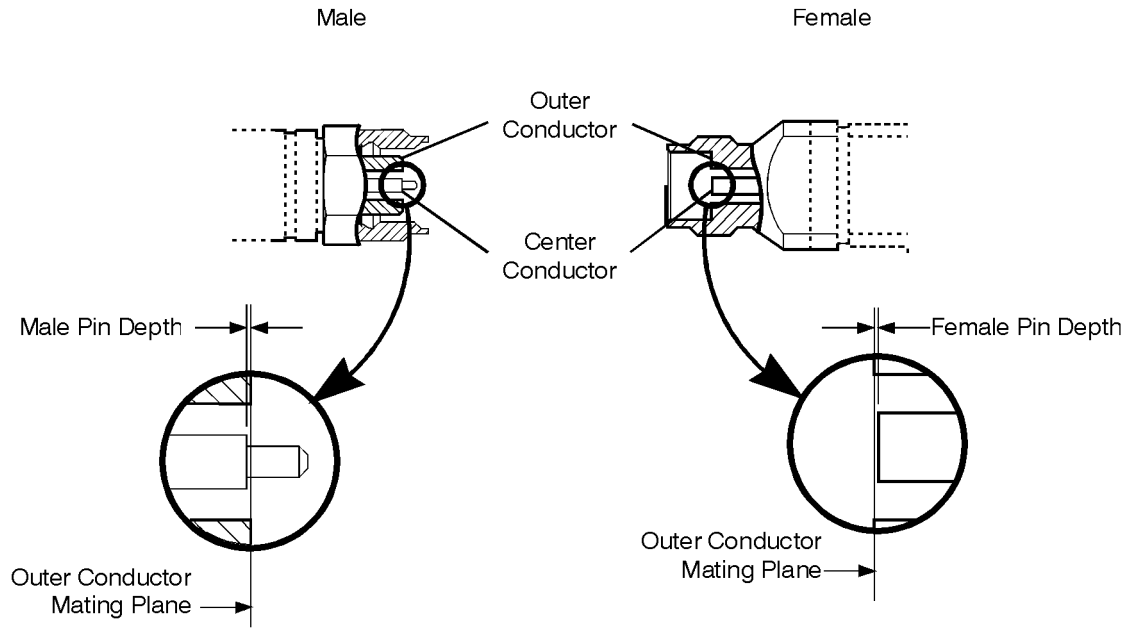

Figure 3-4 Connector Pin Depth

Making Connections

Good connections require a skilled operator. Instrument sensitivity and coaxial connector mechanical tolerances are such that slight errors in operator technique can have a significant effect on measurements and measurement uncertainties.

NOTE

The most common cause of measurement error is poor connections.

Follow these recommendations for optimum connection technique:

1. Clean and inspect (visually and mechanically) all of your connectors.
2. Align connectors carefully. Look for flat physical contact at all points on the mating plane surfaces.

1.0 mm Connector Alignment

If one of the 1.0 mm connectors is free to move, this will make it possible for the connectors to self-align during connection. Self-alignment occurs because outer conductors engage before the center conductors (see Figure 3-5 and Figure 3-6).

1. Make a gentle, preliminary connection.
2. When making a connection, turn *only* the connector nut. Do not rotate a device when you make a connection, and do not apply a lateral or horizontal (bending) force.
3. Use an open-end wrench to keep the device from rotating when you make a final connection with the torque wrench (see Table 4-1 on page 4-1 for ordering information).

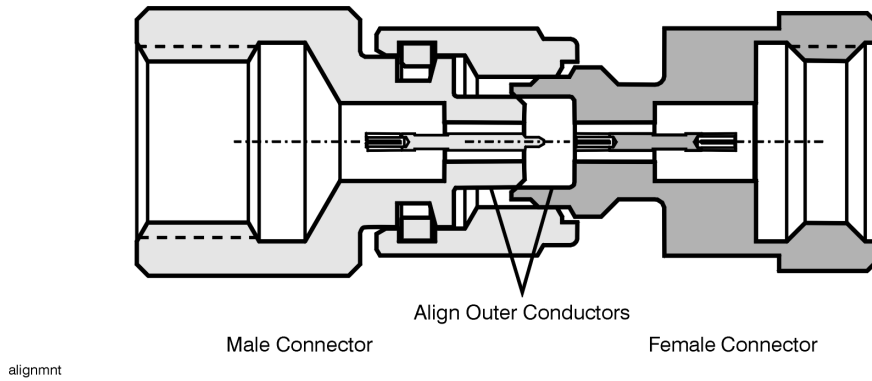

Figure 3-5 Alignment

1.0 mm Connector Misalignment

Forced misalignment could damage the female center conductor.

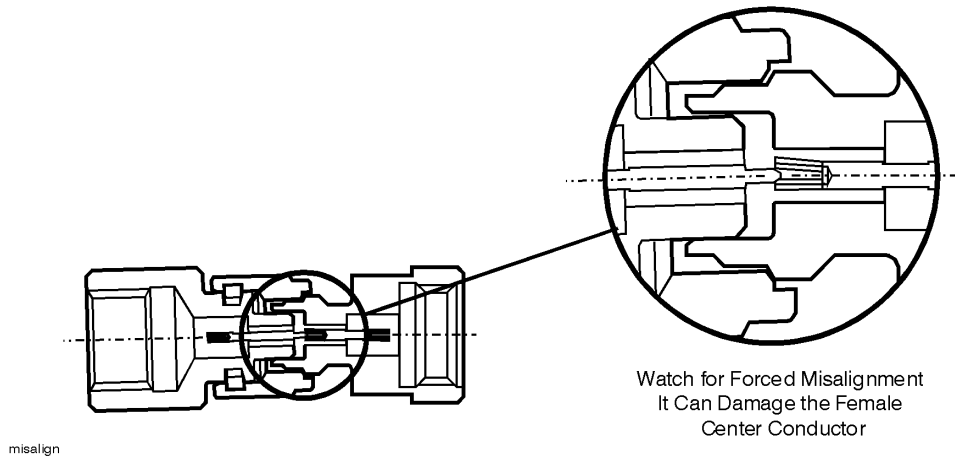

Figure 3-6 Forced Misalignment

NOTE

To achieve misalignment as shown in Figure 3-6 you must use *excessive* force.

Cleaning Connectors

Supplies and Equipment Needed

The supplies and equipment that are needed to perform the cleaning procedures, and their Hewlett-Packard part numbers are listed in Table 4-1.

NOTE

A minimum magnification of 10X is required for all inspections of the adapter parts.

Basic Cleaning Procedure

1. Inspect the connectors for dust, dirt, metal fragments, oils or films, and debris.
2. Blow off any dust with a filtered, clean supply of compressed air.
3. Add a few drops of high-purity isopropyl alcohol to small cleaning swab (do not apply alcohol directly to the parts).

NOTE

When using isopropyl alcohol to clean connectors *do not* allow liquid to flow down inside the connector. This may cause measurement errors due to residue inside the connector. If possible keep the connector facing down.

4. *Gently* wipe connecting surfaces with the end of the cleaning swab (see Figure 3-7).
5. Blow dry with a clean supply of compressed air.
6. Inspect and repeat cleaning procedure if necessary.

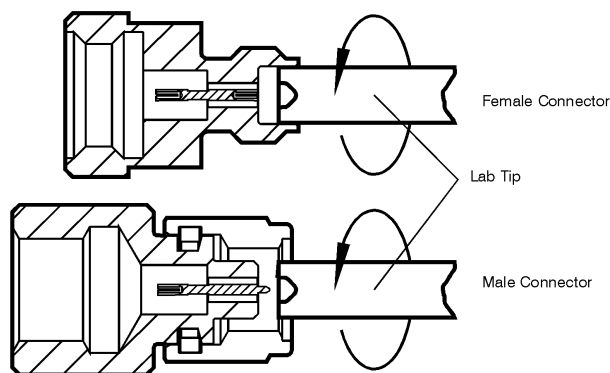

cleaning

Figure 3-7 Cleaning Illustration

Making a Connection

Connection Procedure

1. Ground yourself and all devices (wear a grounded wrist strap and work on an antistatic mat).
2. Visually inspect the connectors (refer to “Visual Inspection” on page 3-2).
3. If necessary, clean the connectors (refer to “Cleaning Connectors” on page 3-9).
4. Carefully align the connectors. The male connector center pin must slip concentrically into the contact fingers of the female connector (see Figure 3-5 and Figure 3-6).
5. Push the connectors straight together. Do *not* twist or screw them together. As the center conductors mate, there is usually a slight resistance.

CAUTION

Do *not* twist one connector into the other (like inserting a light bulb). This happens when you turn the device body, rather than the connector nut. Major *damage* to the center conductor and the outer conductor can occur if the device body is twisted.

6. Initial tightening can be done by hand, or with a 6 mm open-end wrench. Tighten until “snug” or where the connectors are first making contact. The preliminary connection is tight enough when the mating plane surfaces make uniform, light contact. Do *not overtighten* this connection.

At this point, all you want is for the outer conductors to make gentle contact on both mating surfaces. Use very light finger pressure (no more than 2 inch-pounds of torque).

7. Relieve any side pressure on the connection from long or heavy devices or cables. This assures consistent torque (refer to “Using the Torque Wrench”).

Connecting Waveguides

The waveguide mating planes are precision flanges that you must *carefully* screw together. Flat contact between the connectors at *all* points on their mating plane surface is required for a good connection. Inspect the mating surfaces for any gaps, or any condition that will not allow the surfaces to lay flat. *Always* connect waveguide in the same flange orientation using an X pattern (for equal compression).

Using the Torque Wrench

Table 3-1 provides information on the torque wrench required for the connector type of your adapter.

Table 3-1 Torque Wrench Information

Connector Type	Torque Setting	Torque Tolerance
1.0 mm	45 N-cm (4 in-lb)	5.4 N-cm (± 0.5 in-lb)

Torque Wrench Procedure

Using the torque wrench guarantees that a connection is not too tight. This will help prevent possible connector damage. It also guarantees that all connections are equally tight each time.

Do not pre-tighten so much that there is no rotation of the nut with the torque wrench. Static friction must *not* be present during torquing.

Rotate *only* the connector nut when you tighten the connector. In *all* situations, the use of an open-end wrench to keep the body of the device from turning is recommended.

Disconnection Procedure

To avoid lateral (bending) force on the connector mating plane surfaces, always support the devices and connections.

1. Use an open-end wrench to prevent the device body from turning.
2. Use another wrench to loosen the connector nut.
3. Complete the disconnection by hand, turning *only* the connector nut.

CAUTION

Do *not* twist one connector out of the other, (like removing a light bulb). Turn the connector nut, not the device body. Major damage to the center conductor and the outer conductor can occur if the device body is twisted.

4. Pull the connectors straight apart without twisting or bending.

Handling and Storage

- Store the adapters with end caps on, in a foam-lined storage case.
- Never store adapters loose in a box, in a desk, or in a bench drawer. This is the most common cause of connector damage during storage.
- Keep connectors clean.
- Do not touch mating plane surfaces. Natural skin oils and microscopic particles of dirt are easily transferred to the connector interface and are very difficult to remove.
- Do not set connectors contact-end down on a hard surface. The plating and the mating plane surfaces can be damaged if the interface comes in contact with any hard surface.
- When you are not using a connector, use plastic end caps over the mating plane surfaces to keep them clean and protected.

Making Connections
Handling and Storage

4

Replaceable Parts

NOTE

There are no internal replaceable parts within the HP V281C/D and HP W281C/D adapters. The 1.0 mm connectors are not considered field reparable and are not listed. If a unit is in need of repair a replacement must be purchased.

The following table lists the HP part numbers necessary for inspection, ESD protection and replacement. To order a listed part, note the description, HP part number, and the quantity desired. Telephone or send your order to the nearest Hewlett-Packard sales and service office (listed in "Support and Service" on page -vii).

Table 4-1 Replaceable Parts

Hewlett-Packard	
Description:	
Items Included With Adapters	
Operating and Service Manual	00281-90056
Waveguide Protective Cap (clear)	1401-0227
Coax Protective Cap (red)	1401-0202
Items Not Included With Adapters	
10X Magnifying Glass	1000-1114
6 mm 4 in-lb Torque Wrench	8710-2079
6 mm Open-end Wrench	8710-2156
Cleaning Swabs	9300-1745
Isopropyl Alcohol (30 ml)	8500-5344
Grounding Wrist Strap	9300-1367
5 Foot Grounding Cord (for wrist strap)	9300-0980
2 x 4 Foot Conductive Table Mat and 15 ft Ground Wire	9300-0797
ESD Heel Strap (for conductive floors)	9300-1126

Index

A

about this manual, 1-1

C

center conductor
 protrusion and pin depth, 2-4
characteristics
 1.0 mm connector, 2-2
 mechanical, 2-2
 supplemental mechanical, 2-2
cleaning process, 3-9
connections, 3-7
 alignment, 3-7
 procedure, 3-10
 waguide, 3-10
connector contacts, 3-3
connectors
 clarifying sex, 1-2
 cleaning, 3-9
 basic procedure, 3-9
 damaged, 3-4
 defects or damage, 3-2
 mating plane surface, 3-4
 wear, 3-4

D

disconnection procedure, 3-12

E

electrostatic discharge, 3-1
environmental requirements, 2-1

F

figure
 adapter dimensions, 2-4
 alignment, 3-8
 cleaning illustration, 3-9
 concentricity female connector, 3-3
 concentricity male connector, 3-4
 connector pin depth, 3-6
 contact integrity, 3-3
 male and female connectors, 1-2
 misalignment, 3-8

G

General, 1-1
general information
 1.0 mm connector overview, 1-1

H

handling and storage, 3-13

I

inspection
 incoming, 1-1
 visual, 3-2

M

maintenance
 preventive, 1-2
making a connection, 3-1

P

part numbers, 7-1
parts
 replacing, 7-1
pin depth, 3-5
protrusion, 3-5
recession, 3-5
visual, 3-6

R

replaceable parts, 7-1

S

serial numbers, 1-1
 label, 1-1
specifications, 2-1
 electrical, 2-2

T

temperature

what to watch for, 2-1

torque wrench

settings and tolerance, 3-11

using, 3-11

visual, 3-10

troque wrench

procedure, 3-11

V

visual inspection

concentricity, 3-3

connector wear, 3-4

contact integrity, 3-3

mating plane surfaces, 3-4

obvious defects or damage, 3-2

required tools, 3-2

visual instpection, 3-2